

**PROJECT SITE**  
Scale 1:60000



**NACMINE SITE LOCATION PLAN**  
Scale 1:3000

# NACMINE STIRLING DITCH DRAINAGE REALIGNMENT

DRAWING LIST	
SHEET NUMBER	SHEET TITLE
C-101	SITE LOCATION PLAN AND DRAWING LIST
C-102	STIRLING DITCH REALIGNMENT PLAN
C-103	STIRLING DITCH REALIGNMENT PLAN, PROFILE AND TYP SECTIONS
C-103	STIRLING DITCH REALIGNMENT SAMPLED SECTIONS



Rev	Date	Des	Dwn	Chk	Description
0	2023-04-20	SW	JH	JS	ISSUED FOR TENDER

DRUMHELLER RESILIENCY & FLOOD MITIGATION OFFICE			
SITE LOCATION PLAN AND DRAWING LIST			
Project No.	CW2384	Drawing No.	C-101
Group	CIVIL	Rev.	0



Paper Size - ANSI D  
 At Full Size, this border measures 20 mm x 80 mm  
 170  
 150  
 100  
 50  
 0  
 millimeters

**PLAN - STIRLING DITCH REALIGNMENT**  
 Scale 1:600

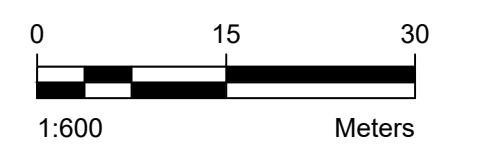

Seal

Rev	Date	Des	Dwn	Chk	Description
0	2023-04-20	SW	JH	JS	ISSUED FOR TENDER

<b>DRUMHELLER RESILIENCY &amp; FLOOD MITIGATION OFFICE</b>			
<b>STIRLING DITCH REALIGNMENT PLAN</b>			
Project No.	CW2384	Drawing No.	C-102
Group	CIVIL	Rev.	0

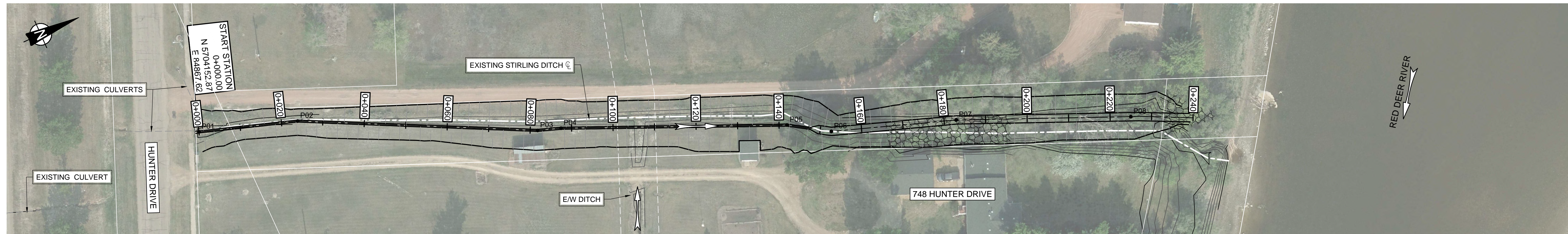

**PLAN - STIRLING DITCH UPGRADE CENTERLINE**

Scale 1:500

LAYOUT TABLE: (STIRLING UPGRADE DITCH BOT)			
POINT	NORTHING (m)	EASTING (m)	ELEV (m)
P01	5704152.89	84867.63	684.80
P02	5704175.79	84874.50	684.69
P03	5704228.12	84899.18	684.02
P04	5704233.53	84900.92	684.01
P05	5704283.94	84921.49	683.82
P06	5704293.18	84927.08	683.75
P07	5704321.96	84936.30	683.54
P08	5704360.97	84952.03	683.07

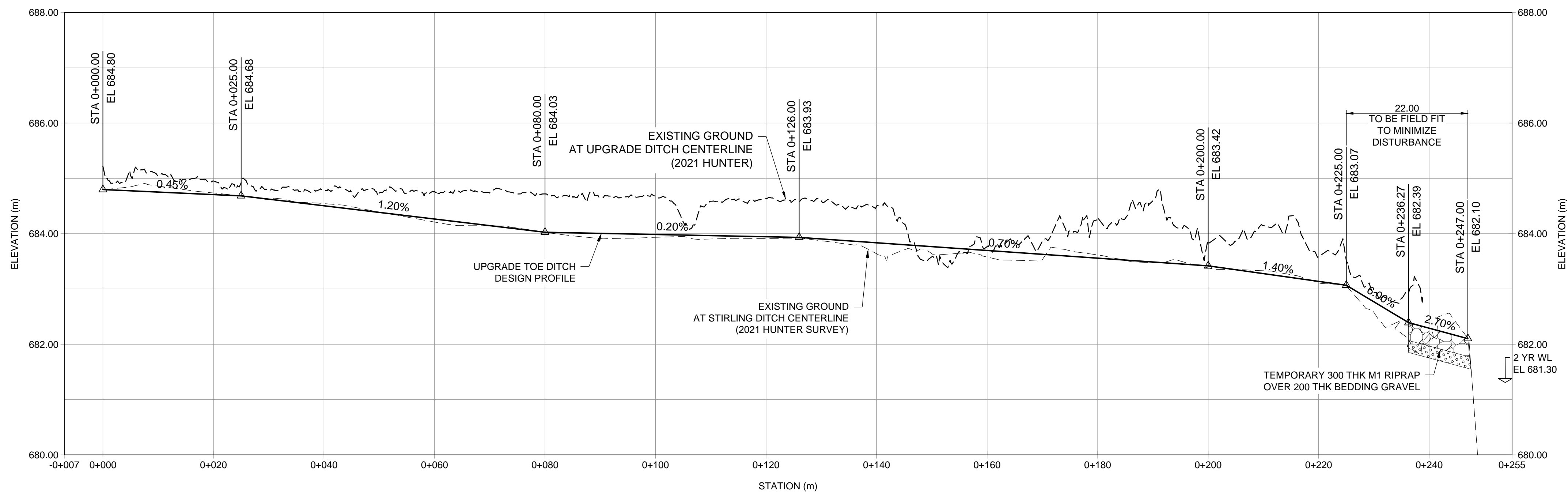

**PROFILE - STIRLING DITCH UPGRADE CENTERLINE**

Scale H 1:500 | V 1:50

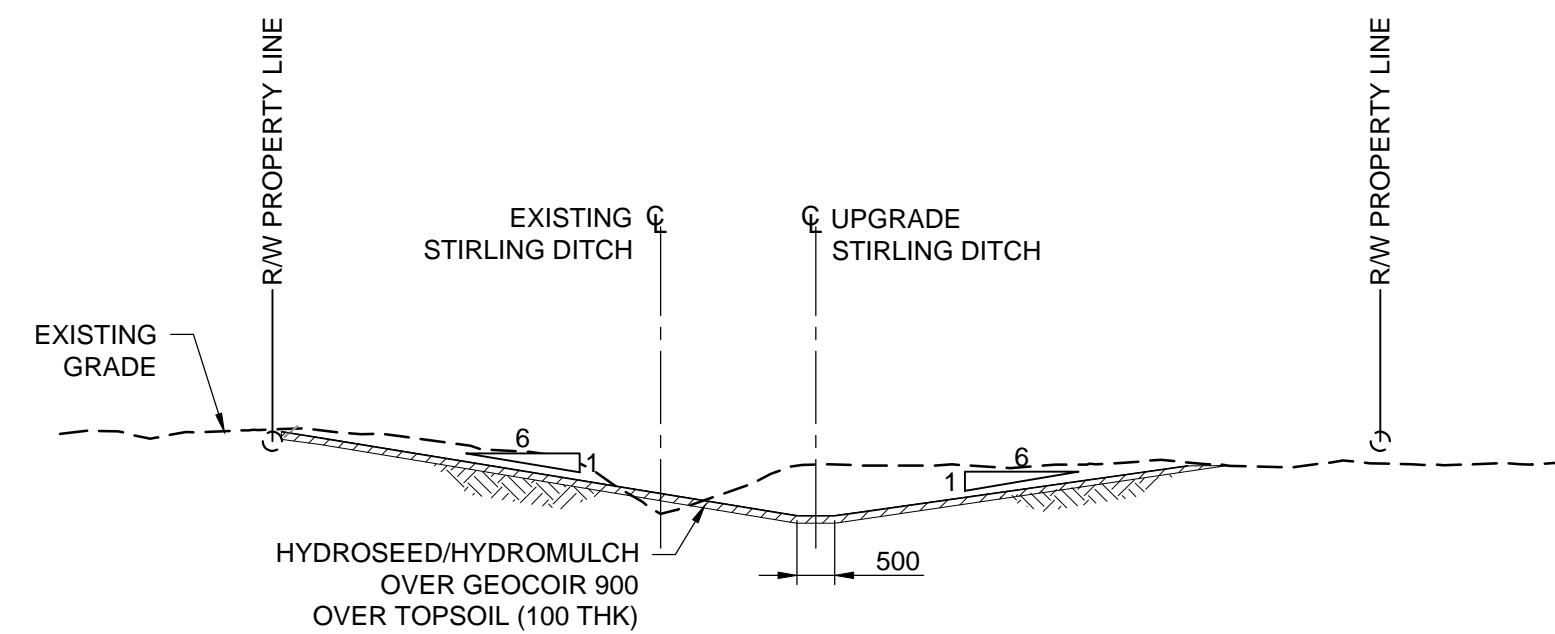

**TYPICAL SECTION - UPGRADE DITCH**

STA 0+000 TO STA 0+150

Scale 1:100

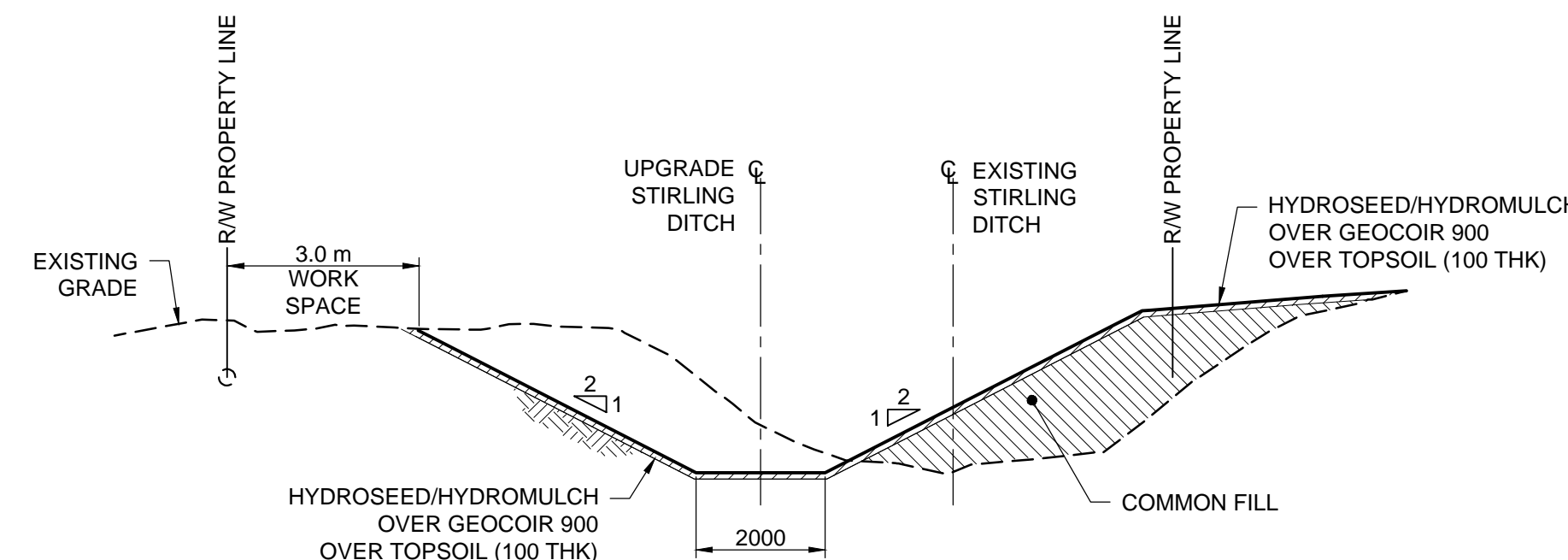

**TYPICAL SECTION - UPGRADE DITCH**

STA 0+150 TO STA 0+165  
STA 0+195 TO STA 0+225

Scale 1:100

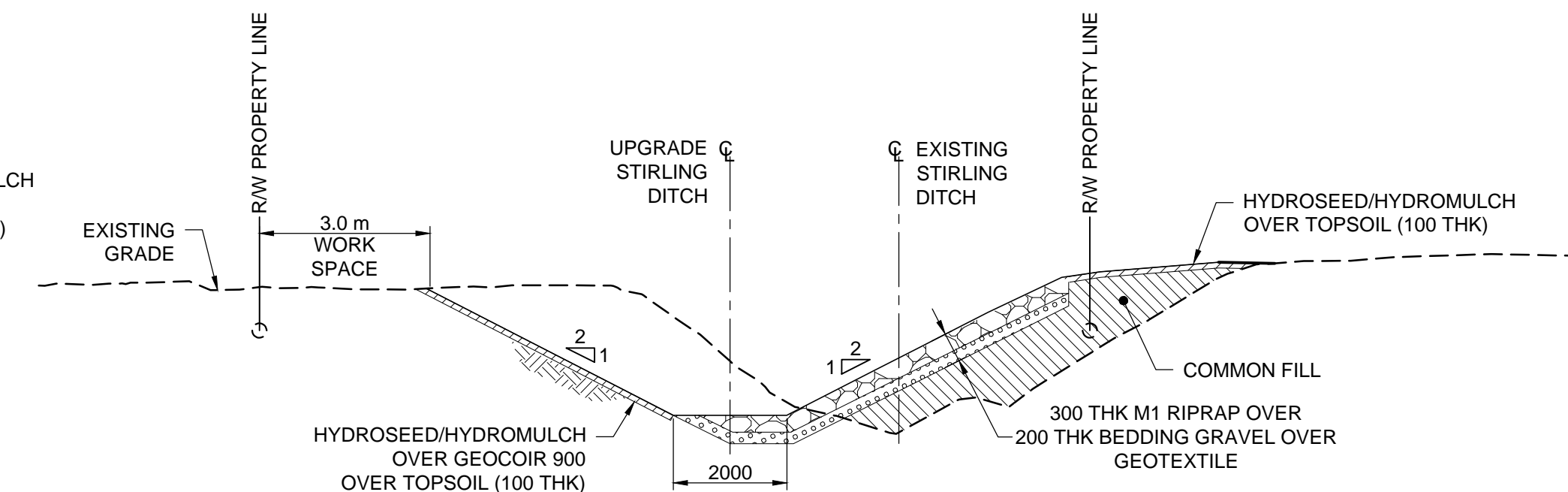

**TYPICAL SECTION - UPGRADE DITCH**

STA 0+165 TO STA 0+195  
ADJACENT TO SCHMIDT PROPERTY

Scale 1:100

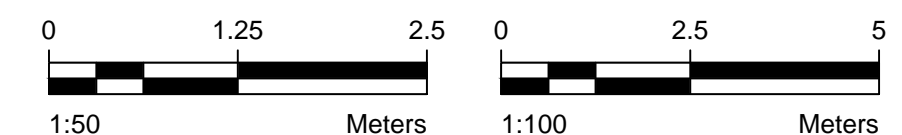

**DRUMHELLER VALLEY**



Rev	Date	Des	Dwn	Chk	Description
0	2023-04-20	SW	JH	JS	ISSUED FOR TENDER

DRUMHELLER RESILIENCY & FLOOD MITIGATION OFFICE

**STIRLING DITCH REALIGNMENT  
PLAN, PROFILE AND TYPICAL SECTIONS**

Project No.	CW2384	Drawing No.		Rev.	
Group	CIVIL		C-103	0	

Paper Size - ANSI D  
 At Full Size, this border measures 320 mm x 80 mm  
 100  
 50  
 0  
 millimeters

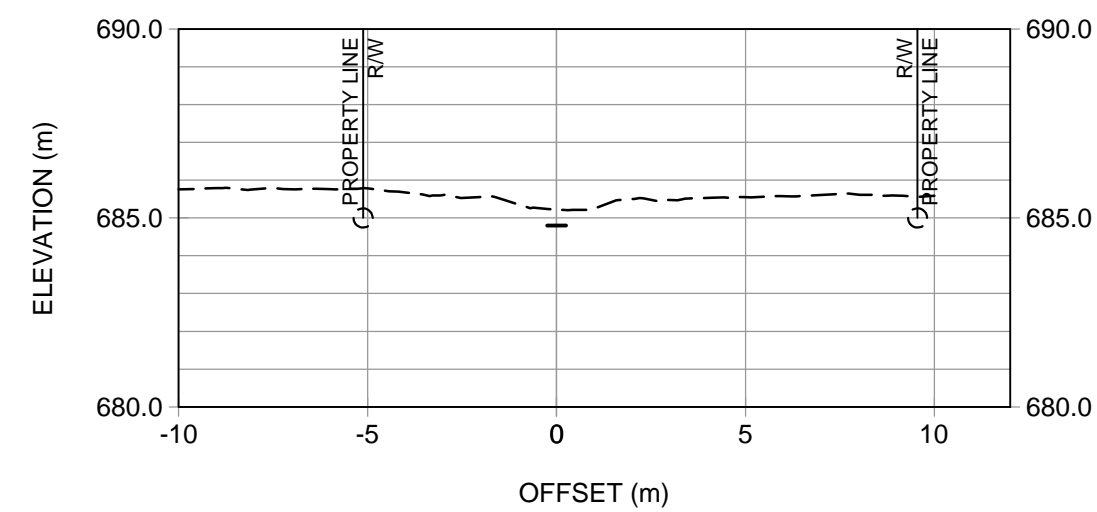

0+000.00

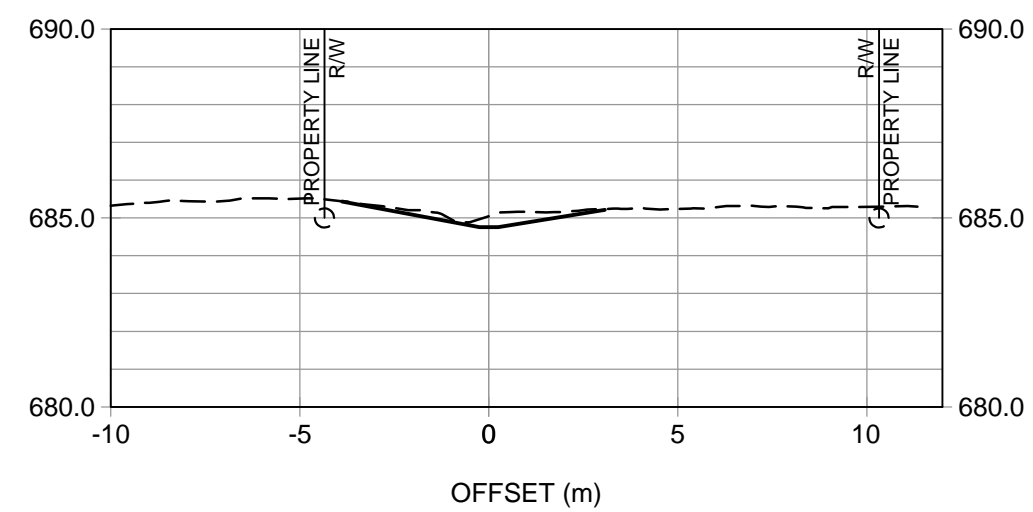

0+010.00

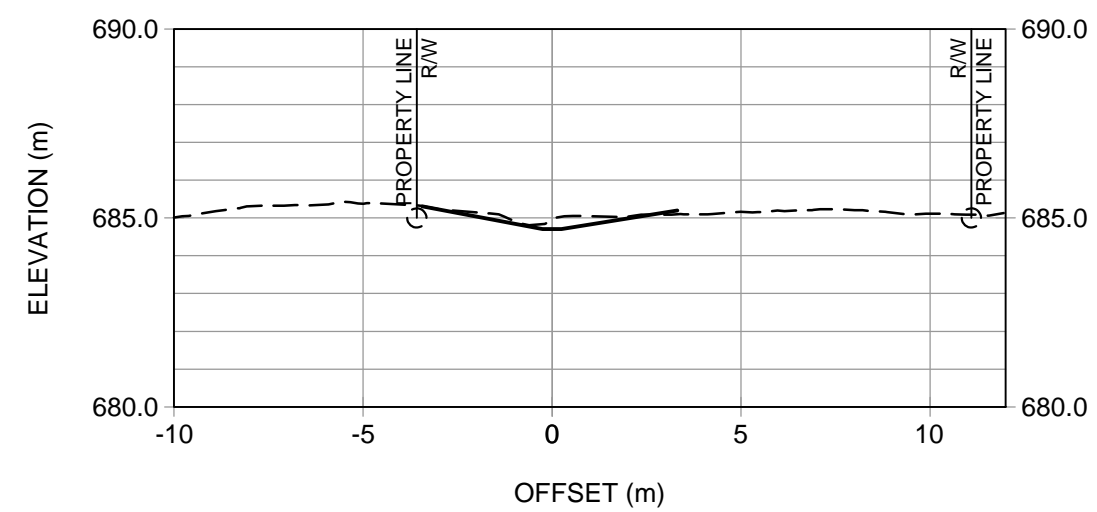

0+020.00

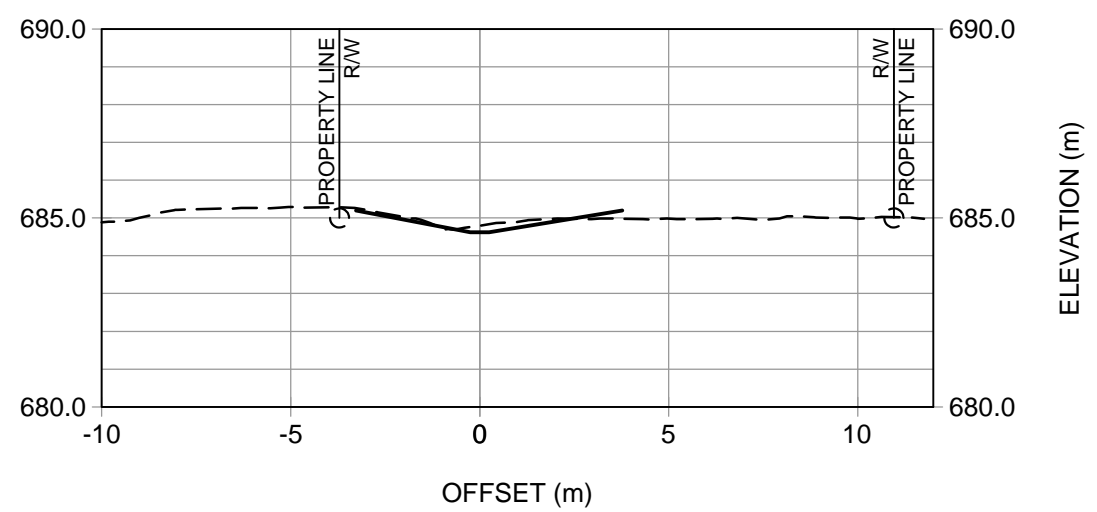

0+030.00

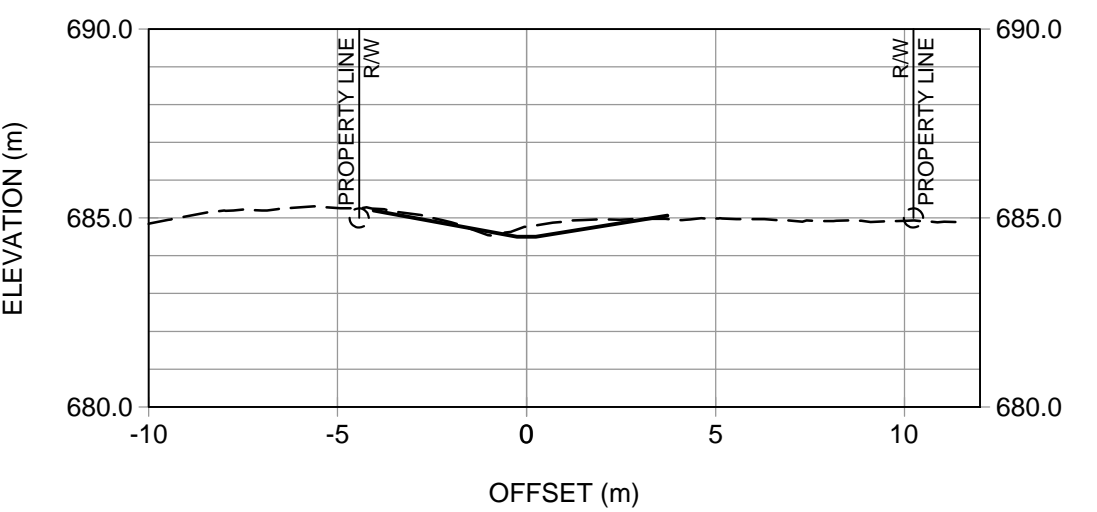

0+040.00

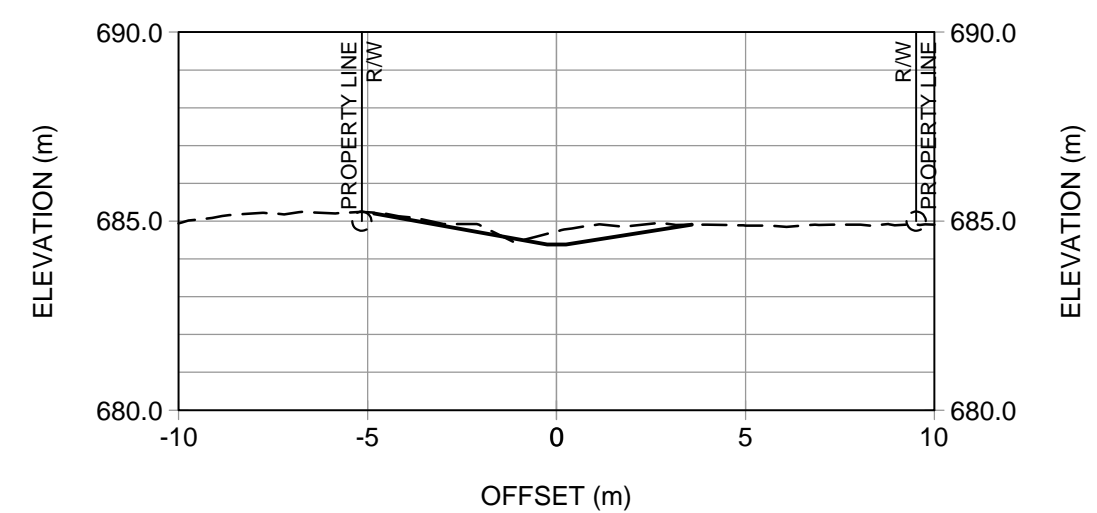

0+050.00

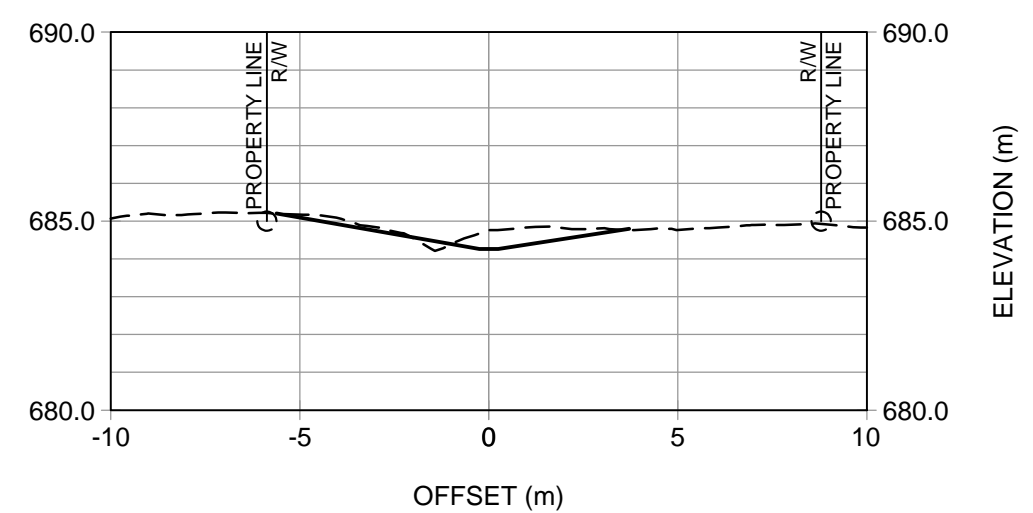

0+060.00

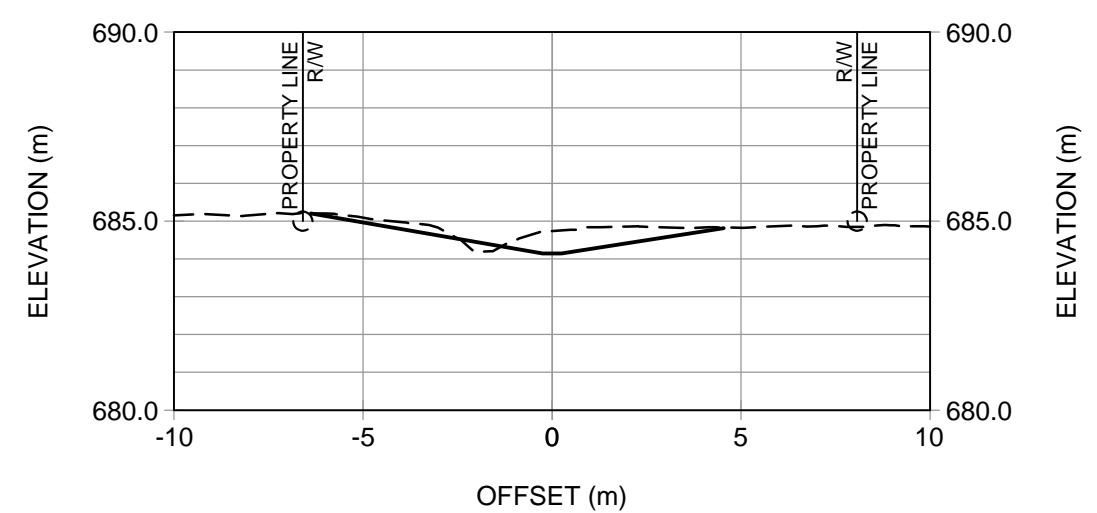

0+070.00

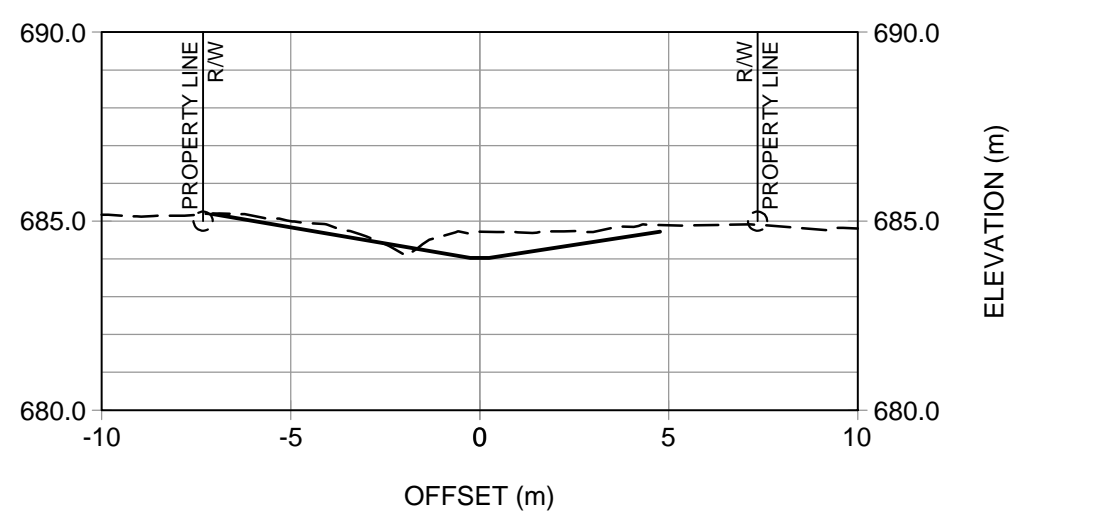

0+080.00

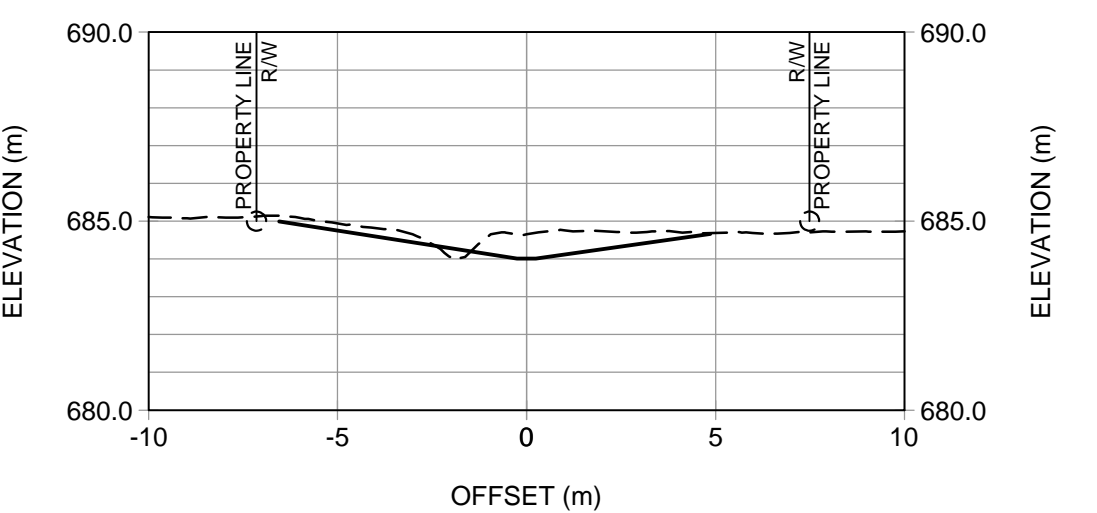

0+090.00

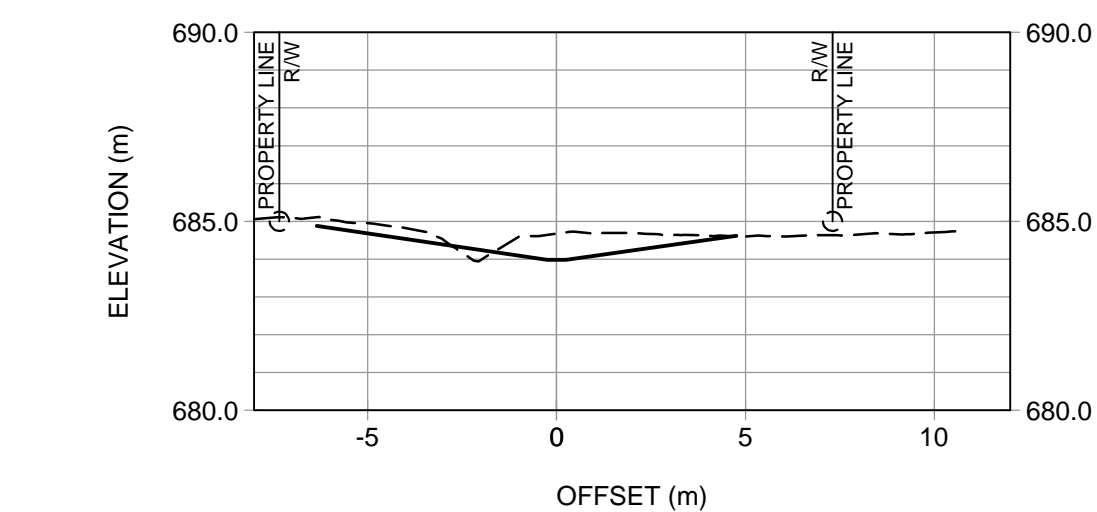

0+100.00

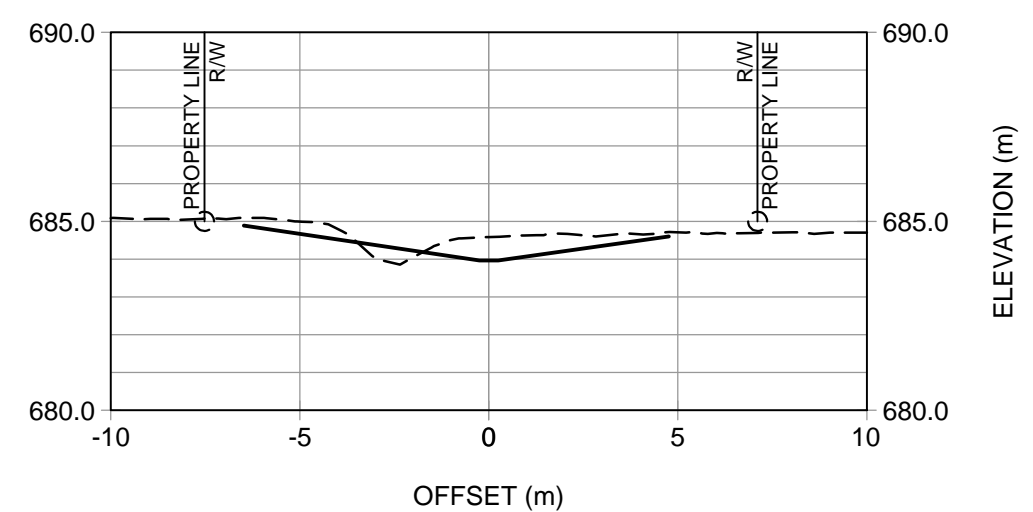

0+110.00

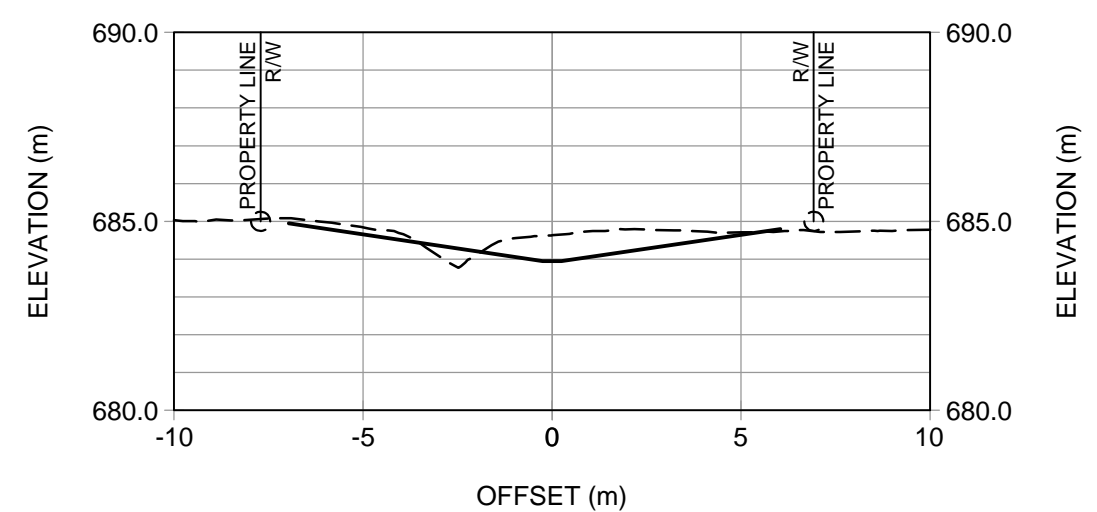

0+120.00

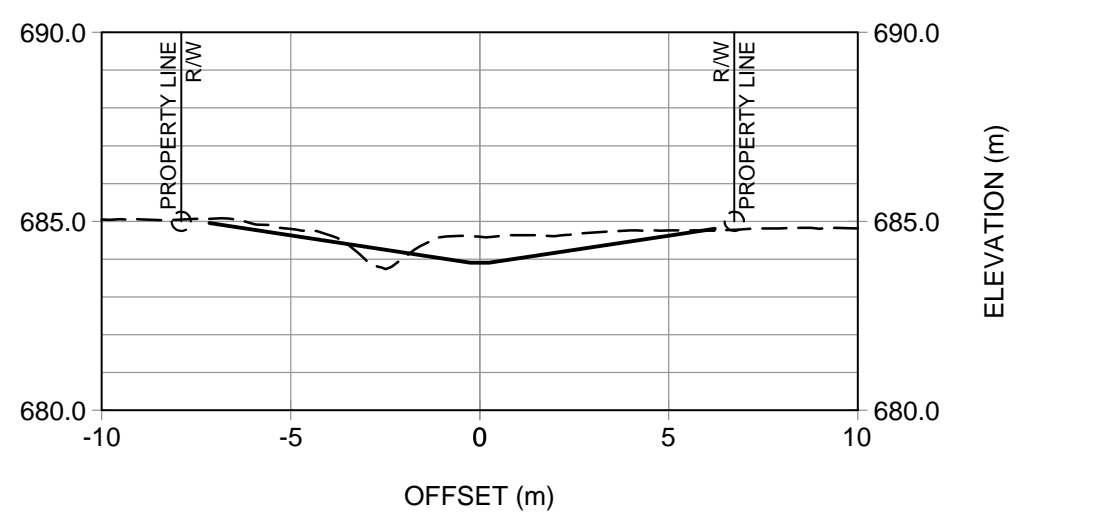

0+130.00

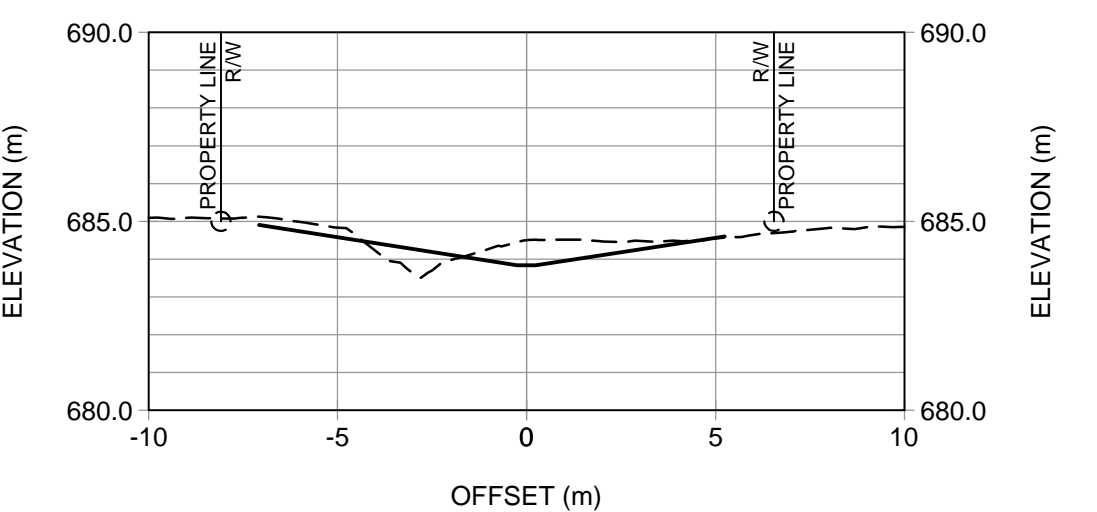

0+140.00

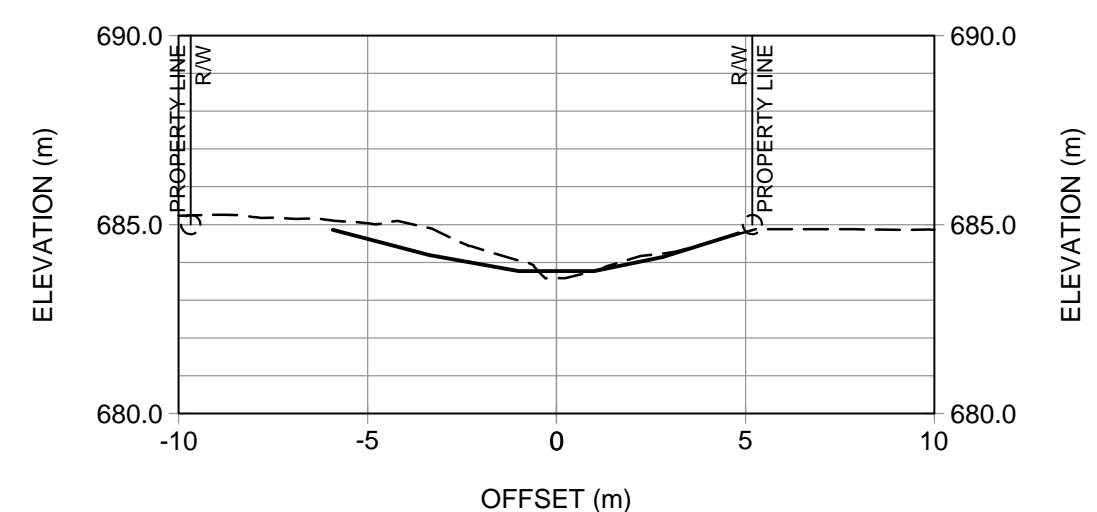

0+150.00

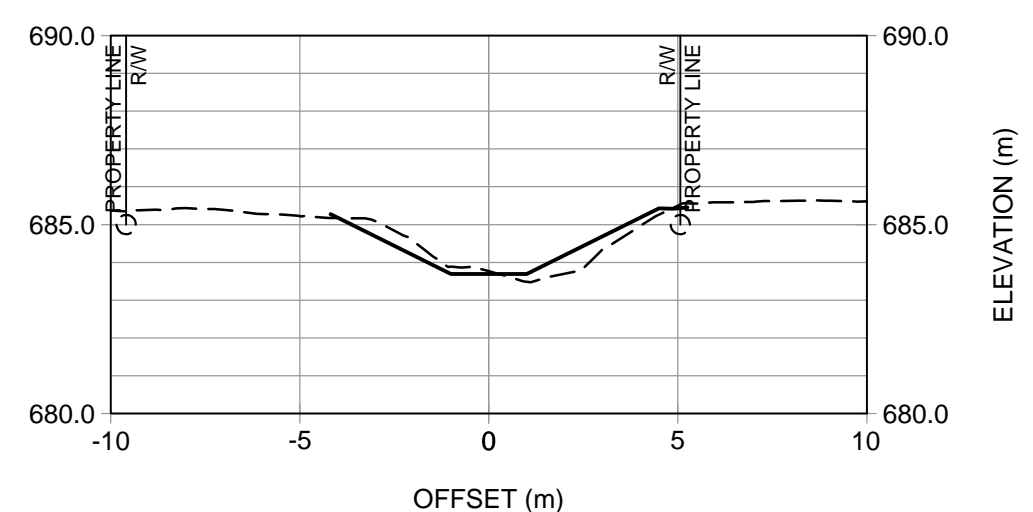

0+160.00

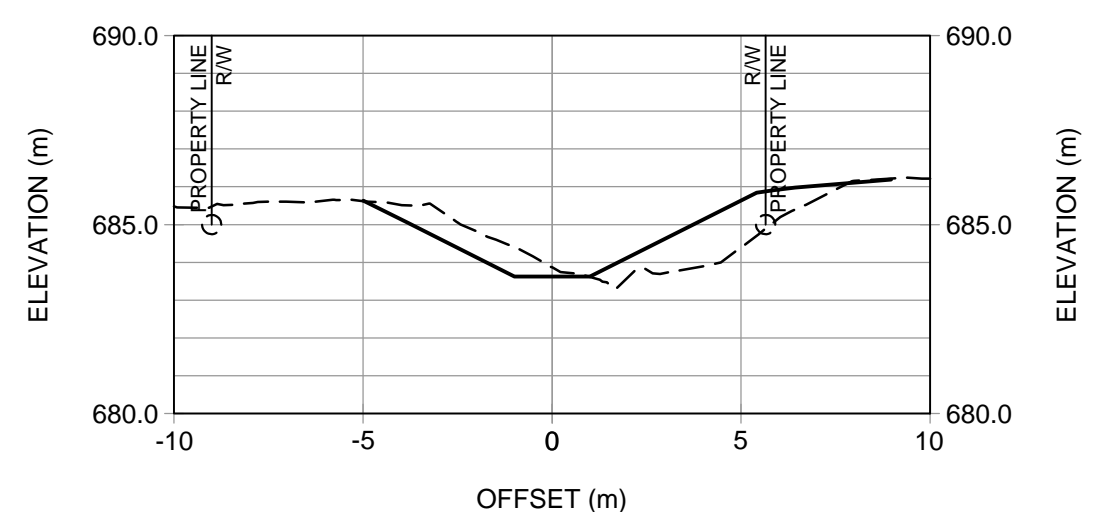

0+170.00

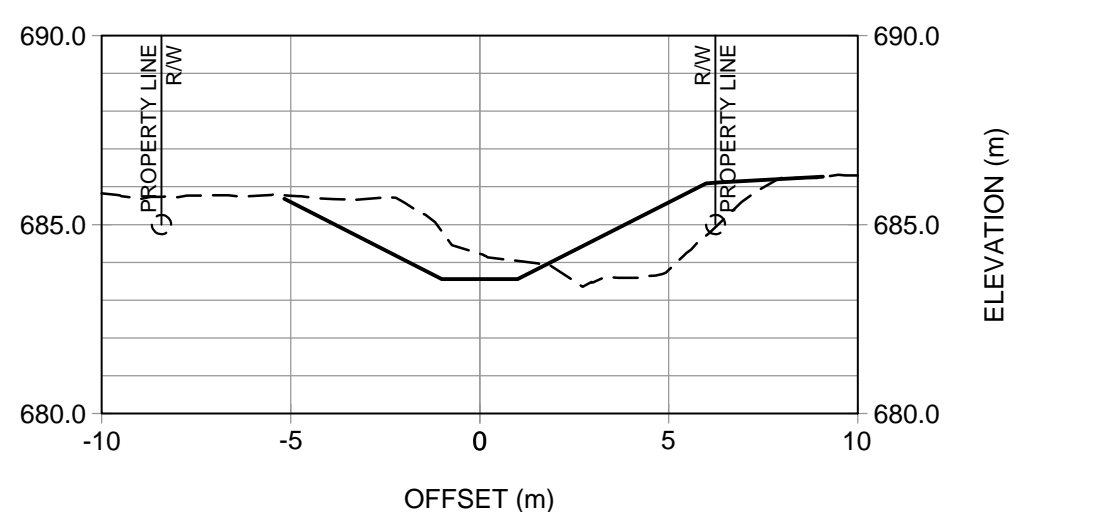

0+180.00

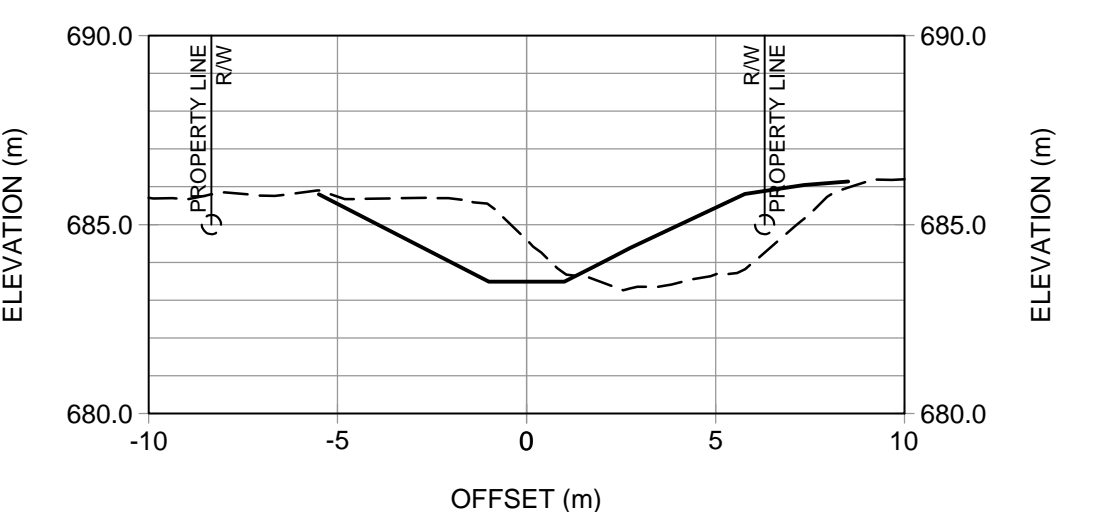

0+190.00

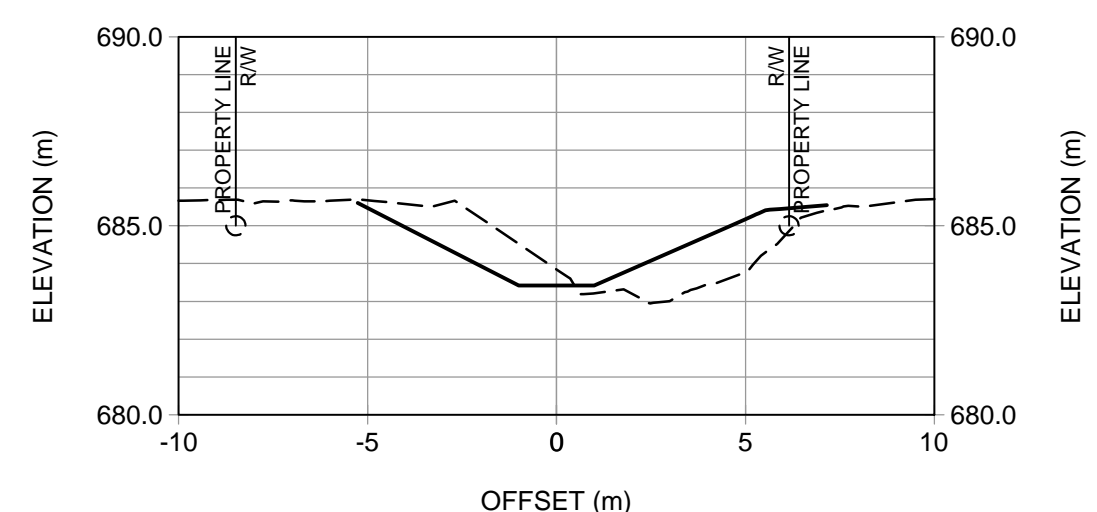

0+200.00

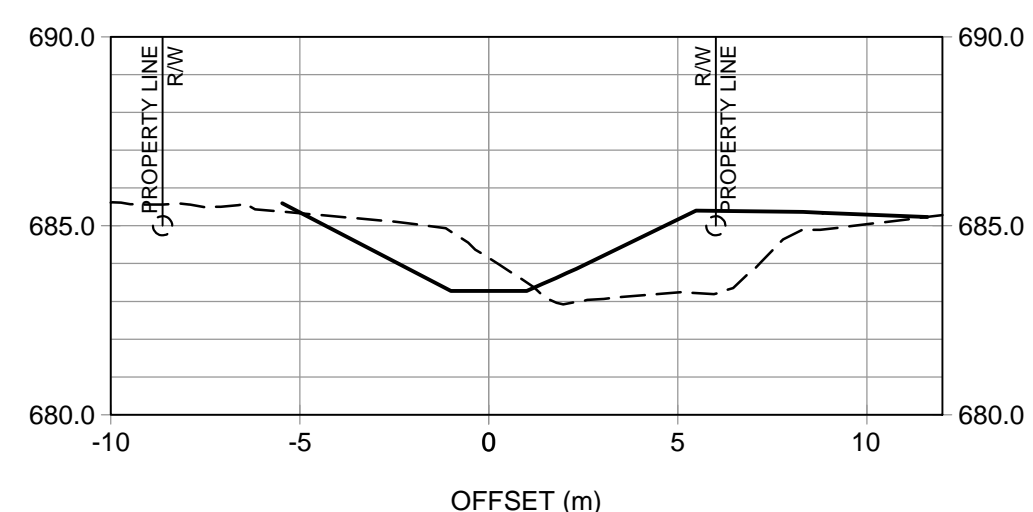

0+210.00

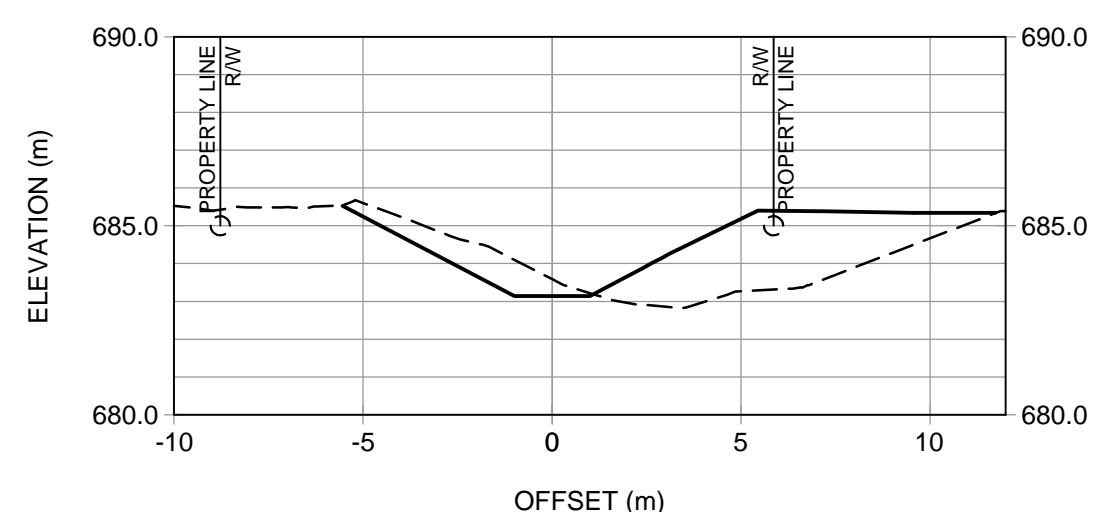

0+220.00

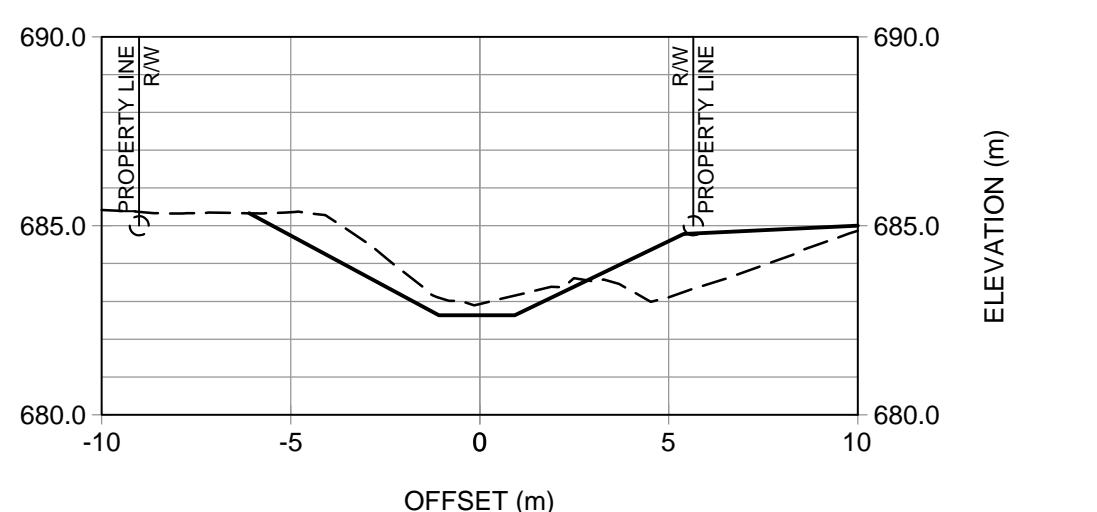

0+230.00

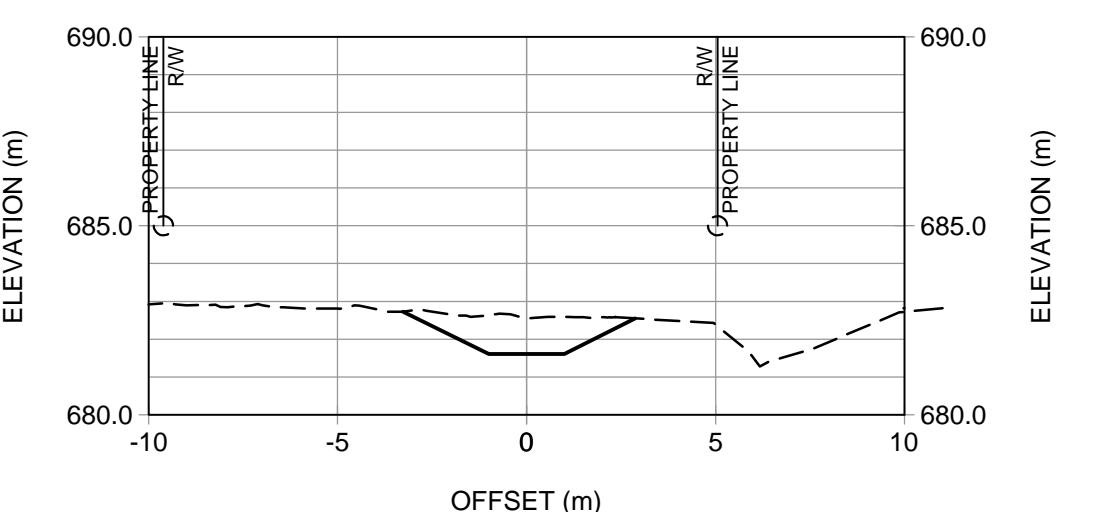

0+240.00

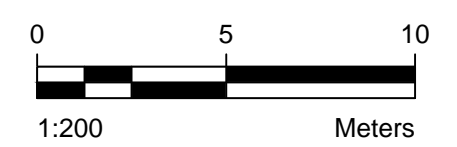

Seal

Rev	Date	Des	Dwn	Chk	Description
0	2023-04-20	SW	JH	JS	ISSUED FOR TENDER

DRUMHELLER RESILIENCY & FLOOD MITIGATION OFFICE			
<b>STIRLING DITCH REALIGNMENT SAMPLED SECTIONS</b>			
Project No.	CW2384	Drawing No.	
Group	CIVIL		C-104 0